



Stanfords
Estate Agents



Brunswick Place

, Hove BN3 1ND

- AVAILABLE 4th OCTOBER 2024
- ONE DOUBLE BEDROOM
- SITUATED IN A REGENCY BUILDING
 - OVER TWO FLOORS
- VIEWINGS HIGHLY RECOMMENDED
- OPEN PLAN LIVING AND KITCHEN WITH APPLIANCES
- MODERN THROUGHOUT
- EXCELLENT HOVE LOCATION
 - UNFURNISHED
- STUDENTS WELCOME

£1,350 PCM

**Local Authority Brighton &
Hove City Council
Council Tax Band A
EPC Rating D**

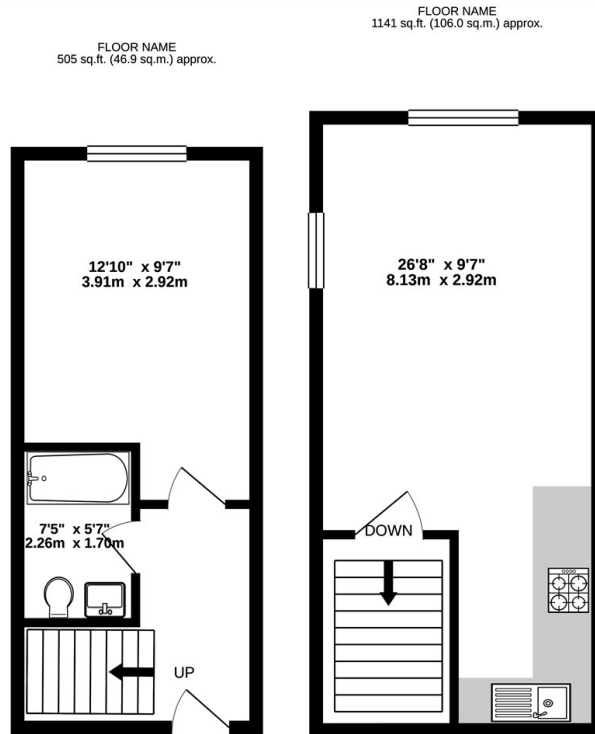

TOTAL FLOOR AREA: 505sq.ft. (46.9 sq.m.) approx.
Whilst every attempt has been made to ensure the accuracy of the floorplan contained here, measurements of doors, windows, rooms and any other items are approximate and no responsibility is taken for any error, omission or mis-statement. This plan is for illustration purposes only and should be used as such by any prospective purchaser. The services, systems and appliances shown have not been tested and no guarantee as to their operability or efficiency can be given.
Made with Metropex 05001



Stanfords Lettings Office
30-31 North Street, Brighton,
East Sussex, BN1 1EB

Contact
01273 733334
lettings@stanfords-
estates.com
www.stanfords-estates.com

Agents Note: Whilst every care has been taken to prepare these particulars, they are for guidance purposes only. All measurements are approximate and for general guidance purposes only and whilst every care has been taken to ensure accuracy, they should not be relied upon and potential buyers/tenants are advised to recheck the measurements.